

**PERMANENT
TP-125**

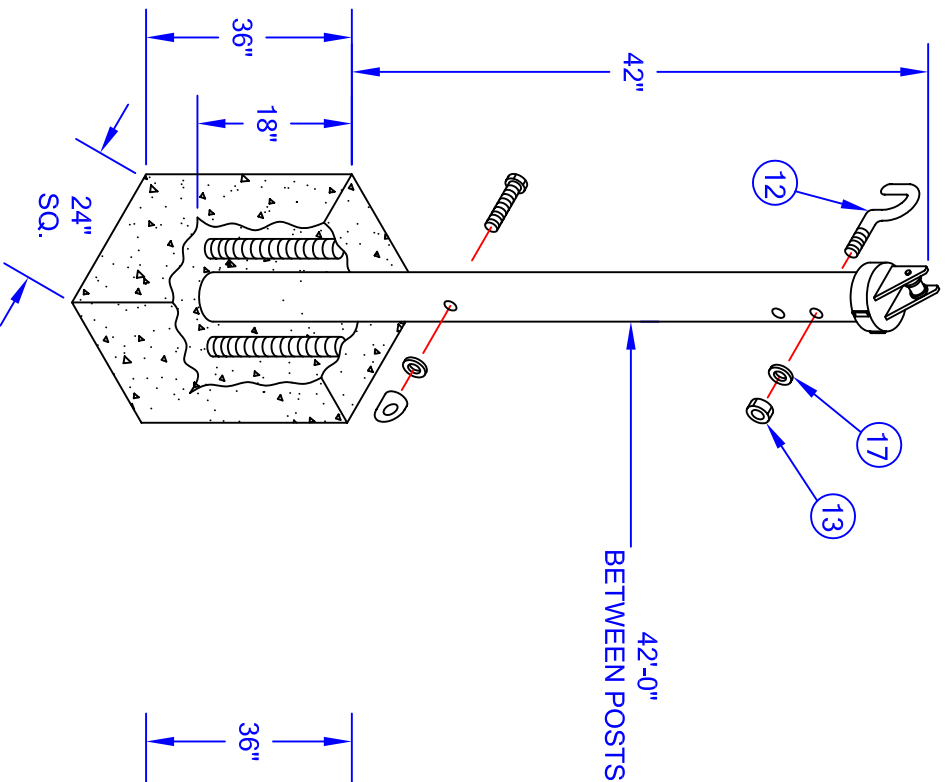

**SEMI-PERMANENT
TP-150**

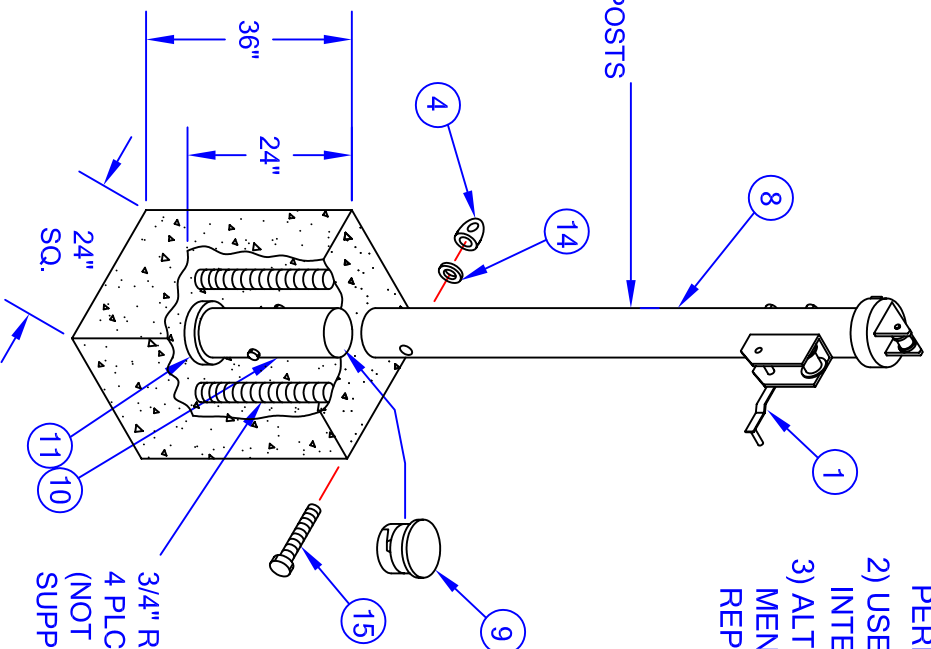

- PLEASE NOTE:**
- 1) FOR SAFE OPERATION AND CONTINUED HIGH PERFORMANCE FROM THIS EQUIPMENT, INSPECTION AND MAINTENANCE MUST BE PERFORMED BEFORE EACH USE
 - 2) USE OF THIS EQUIPMENT OTHER THAN INTENDED, MAY BE HAZARDOUS.
 - 3) ALTERATION OR MODIFICATION OF EQUIPMENT MAY BE HAZARDOUS. FOR REPAIR OR REPLACEMENT, PLEASE CALL YOUR DEALER

**SEE REVERSE SIDE
FOR PULLEY AND
BUCKLE ASSEMBLIES**

**3/4" REBAR x 36"
4 PLC PER FOOTING
(NOT INCLUDED, TO BE
SUPPLIED BY INSTALLER)**

THESE ARE MINIMUM SUGGESTED DIMENSIONS FOR AVERAGE SOIL CONDITIONS.

NOTE: CONCRETE SPECIFIED SHOULD BE 4000# MIN. CURING TIME SHOULD BE 14 DAY MIN. BEFORE PUTTING INTO SERVICE.

Jaypro Sports

976 Hartford Turnpike

Waterford, CT 06385 USA

(800)243-0533

(800)988-3363 Fax

www.jaypro.com

**MODEL NO.:
TP-125/150**

**PRODUCT NAME:
PERMANENT AND SEMI-PERMANENT
TENNIS POSTS**

DRAWN BY: JAC

EFFECTIVE DATE:
4-23-03

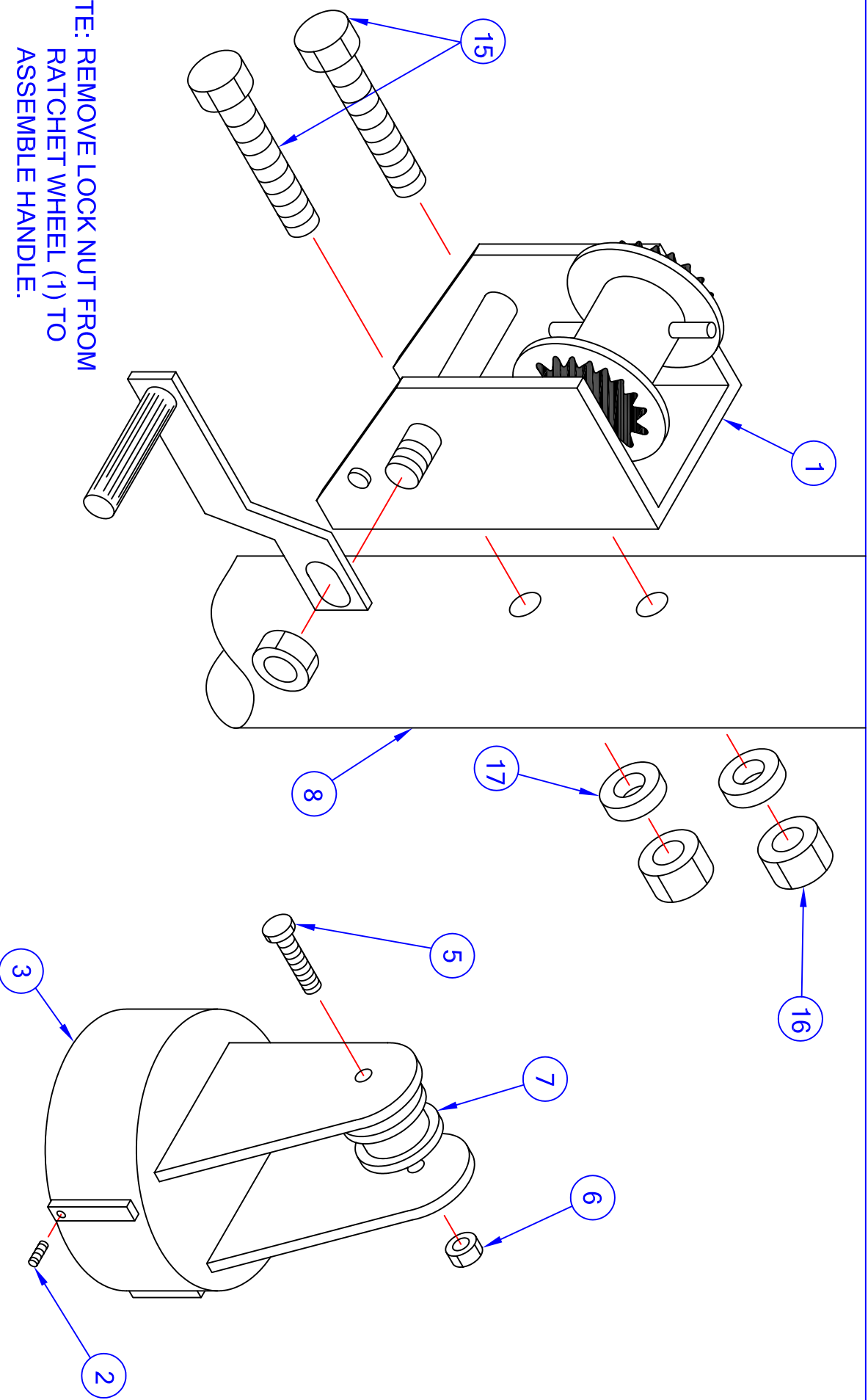

NOTE: REMOVE LOCK NUT FROM RATCHET WHEEL (1) TO ASSEMBLE HANDLE.

CAUTION: DO NOT RELEASE HANDLE UNLESS RATCHET PAWL IS PROPERLY ENGAGED. DO NOT DISENGAGE RATCHET PAWL UNLESS TENSION IS APPLIED TO HANDLE. FAILURE TO OBSERVE THESE CAUTIONS WILL CAUSE HANDLE TO SPIN OUT OF CONTROL AND COULD CAUSE PERSONAL INJURY.

Jaypro Sports

976 Hartford Turnpike
 Waterford, CT 06385 USA
 (800)243-0533
 (800)988-3363 Fax
 www.jaypro.com

MODEL NO.:
TP-125/150

PRODUCT NAME:
 PULLEY AND BUCKLE ASSEMBLIES

DRAWN BY: JAC
EFFECTIVE DATE: 4-23-03

JAYPRO SPORTS

PERMANENT AND SEMI-PERMANENT TENNIS POSTS, TP-125/150 LIST OF MATERIALS

<u>PIECE NO.</u>	<u>PART NO.</u>	<u>DESCRIPTION</u>	<u>QTY.</u>
1	RT-5	RATCHET WHEEL WITH HANDLE	1
2	HS324	SET SCREW 3/8"-16 x 1/2"	4
3	AF71	PULLEY CAP	2
4	HN2949	EYENUT 3/8"-16	2
5	05319	HEX HEAD SCREW 1/4"-20 x 2"	2
6	HN256	LOCK NUT 1/4"-20	2
7	AF737	PULLEY	2
8	TP1252	UPRIGHT ASSEMBLY	2
9	AF1213A	SLEEVE-TOP CAP (TP-150 ONLY)	2
10	AP5010	GROUND SLEEVE (TP-150 ONLY)	2
11	RP717	SLEEVE-BOTTOM CAP (TP-150 ONLY)	2
12	HB852	U-BOLT 3/8"-16 x 4"	1
13	HN265	LOCK NUT 3/8"-16	1
14	HW337	LOCK WASHER 3/8"	2
15	HS856	HEX HEAD BOLT 3/8"-16 x 4"	4
16	HN1230	THIN LOCK NUT 1/2"-13	2
17	HW2047	FLAT WASHER 3/8"	3

IMPORTANT

FOR TENNIS SLEEVE INSTALLATION, SET SLEEVES 42'-3 1/2" ON CENTER.

FOR OUTDOOR VOLLEYBALL INSTALLATION, SET SLEEVES 36' ON CENTER.

TP-150, SEMI-PERMANENT TENNIS POSTS SLEEVE INSTALLATION INSTRUCTIONS

Set ground sleeves exactly 42'-3 1/2" on center (42' between posts). This may require the services of a qualified local contractor familiar with the soil conditions and building codes particular to your area. The referenced minimum concrete dimensions are typical for average conditions, but unusual conditions may warrant modifications by the contractor.

IMPORTANT: PROPER INSTALLATION OF THE GROUND SLEEVES IS ESSENTIAL TO THE SUCCESSFUL PERFORMANCE OF THIS UNIT.

NOTE: CONCRETE SPECIFIED SHOULD BE 4000# MIN. CURING TIME SHOULD BE 14 DAY MIN. BEFORE PUTTING INTO SERVICE.