

10-10"
CRITICAL FROM
BOTTOM OF
EXTENSION

RECOMMENDED
DIMENSIONS
FOR AVERAGE
SOIL CONDITIONS

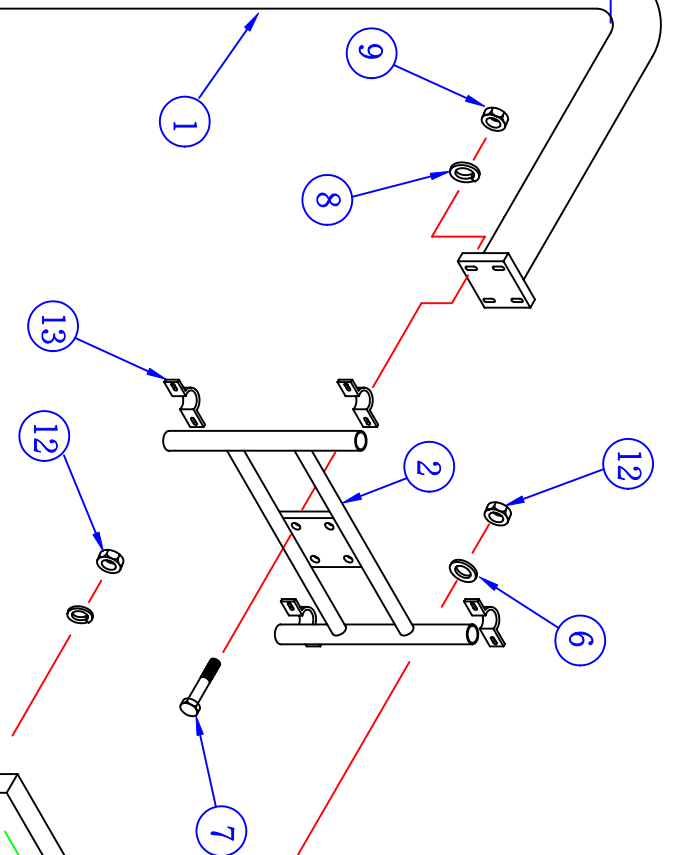

- PLEASE NOTE:
- 1) FOR SAFE OPERATION AND CONTINUED HIGH PERFORMANCE FROM THIS EQUIPMENT, INSPECTION AND MAINTENANCE MUST BE PERFORMED BEFORE EACH USE
 - 2) USE OF THIS EQUIPMENT OTHER THAN INTENDED, MAY BE HAZARDOUS.
 - 3) ALTERATION OR MODIFICATION OF EQUIPMENT MAY BE HAZARDOUS. FOR REPAIR OR REPLACEMENT, PLEASE CALL YOUR DEALER

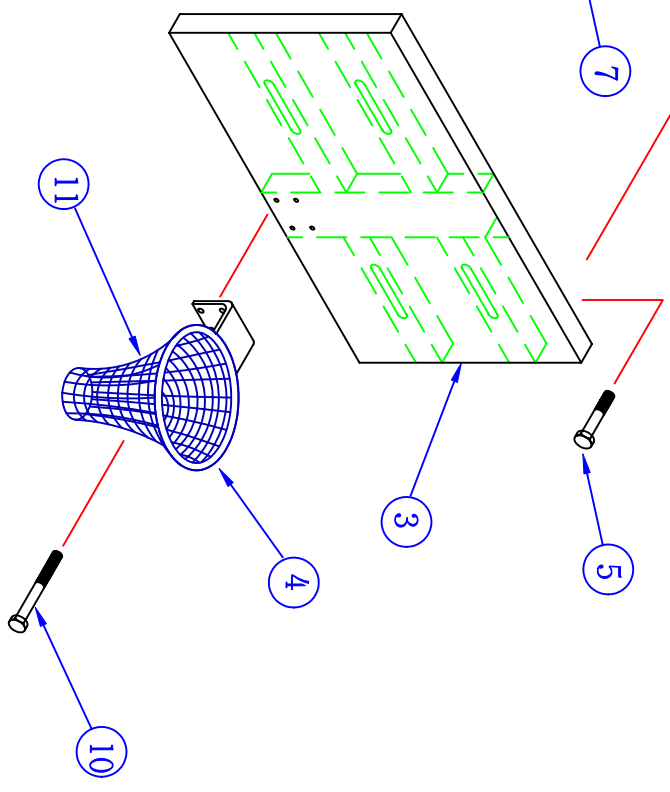

<h1>JAYPRO SPORTS</h1> <p>976 HARTFORD TURNPIKE WATERFORD, CT 06385 USA (800)243-0533 (800)988-3363 FAX WWW.JAYPRO.COM</p>		<p>MODEL NO.:</p> <h2>985-RS-DR</h2>	
<p>PRODUCT NAME:</p> <h3>4 1/2" ROUND POST 4' EXTENSION, H-FRAME</h3>		<p>DRAWN BY: JAC</p>	
<p>EFFECTIVE DATE:</p> <p>7-22-03</p>			

JAYPRO SPORTS

4 1/2" ROUND POST EXTENSION, H-FRAME, 985-RS-DR

LIST OF MATERIALS

<u>PIECE NO.</u>	<u>PART NO.</u>	<u>DESCRIPTION</u>	<u>QTY.</u>
1	983U	UPRIGHT	1
2	983ALB-F	BACKBOARD SUPPORT FRAME	1
3	850RB-BB	BACKBOARD 42" x 72"	1
4	GDR-54HP	GOAL	1
5	HSB211	CARRIAGE BOLT 3/8"-16 x 1 1/4"	8
6	HW334	LOCKWASHER 3/8"	12
7	HS297	HEX HEAD BOLT 1/2"-13 x 1 1/4"	4
8	HW2124	LOCKWASHER 1/2"	4
9	HN1241	HEX NUT 1/2"-13	4
10	HS291	HEX HEAD BOLT 3/8"-16 x 2 1/2"	4
11	JNY-4HP	NET	1
12	HN264	HEX NUT 3/8"-16	4
13	HM2883	COLLAR BRACKET	4